





Turin Street, Ipswich, £975 Per month

 2  1  2  C

Grace Estate Agents are pleased to present this well kept two bedroom mid-terraced property close to Ipswich Town Centre to Rent. It benefits from spacious accommodation throughout and a great location.

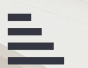
- Mid Terrace Property
- Two Double Bedrooms
- Spacious Open Plan Living
- Modernised Property
- Low Maintenance Garden
- Easy Access to A12/A14
- Town Centre Location
- Offers plenty of storage space
- The landlord is pet friendly, and will consider pets on an individual basis

£975 Per month

Viewing

Please contact our Grace Estate Agents Office on 01473 747728 if you wish to arrange a viewing appointment for this property or require further information.

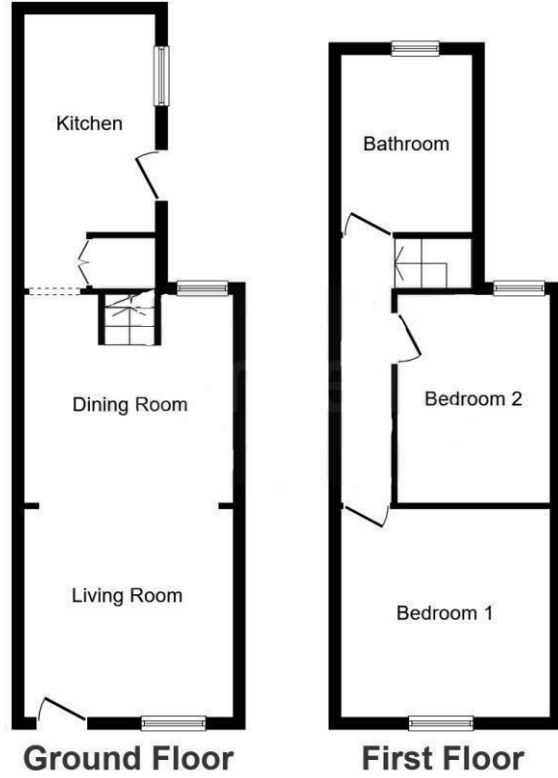

Energy Efficiency Rating		Current	Potential
Very energy efficient - lower running costs			
(92 plus) A			89
(81-91) B			
(69-80) C		70	
(55-68) D			
(38-54) E			
(21-38) F			
(1-20) G			
Not energy efficient - higher running costs			
England & Wales		EU Directive 2002/91/EC	

Environmental Impact (CO ₂) Rating		Current	Potential
Very environmentally friendly - lower CO ₂ emissions			
(92 plus) A			
(81-91) B			
(69-80) C			
(55-68) D			
(38-54) E			
(21-38) F			
(1-20) G			
Not environmentally friendly - higher CO ₂ emissions			
England & Wales		EU Directive 2002/91/EC	

This plan is for illustration purposes only and may not be representative of the property.
Plan not to scale.

Powered by audioagent.com



These particulars, whilst believed to be accurate are set out as a general outline only for guidance and do not constitute any part of an offer or contract. Intending purchasers should not rely on them as statements of representation of fact, but must satisfy themselves by inspection or otherwise as to their accuracy. No person in this firm's employment has the authority to make or give any representation or warranty in respect of the property.